

# BE FO RE TH E



## ABRASIVES FOR METAL FABRICATION

*Get the most demanding jobs done right and done fast.*

800.835.9999 / [weilerabrasives.com](http://weilerabrasives.com)





# CUT THROUGH BARRIERS BETWEEN YOU AND YOUR BEST WORK

Introducing Tiger 2.0 — An evolution in abrasives technology.  
It was designed to be more than just a better product.  
It was created to help you do your best work.

## CUT THROUGH INEFFICIENCY

Tiger 2.0's unique formulation provides the same fast cutting speed, while lasting up to 40% longer. And it's industry first, optimal use line ensures you get more done with less.

## CUT THROUGH SAFETY ISSUES

Tiger 2.0 delivers predictable, smooth cutting and grinding, making the work safer. And it now has a QR code so operators can access crucial safety information right where — and when — they need it.

## CUT THROUGH LABOR SHORTAGES

Tiger 2.0 makes cutting and grinding easier, which means operators aren't as worn out at the end of each shift. The unique formulation also produces more consistent work from user to user, reducing training time and even re-work.

# 3X

*Tiger 2.0 cuts through the barriers holding you back from realizing gains while reducing costs. In some cases, users are seeing **3 times more efficiency** over their previous abrasives.*





**NEW 2.0**

*Weiler Tiger 2.0 cutting, grinding, and combo wheels are the next evolution in abrasives.*



### OPTIMUM USE LINE

Using the wheel to its full life reduces change-overs, which helps users be more productive while reducing waste and abrasive spend.

### NOW AVAILABLE

in AO, Zirc, Inox and Ceramic



QR code provides quick access to important safety information.

### IMPROVE SAFETY



### FAST SPEED + LONGER LIFE

Up to **40% longer wheel life** reduces change-overs and delivers more cuts.



Tiger 2.0



Industry Standard

### ANTI-CHIPPING TECHNOLOGY

Advanced 2.0 bond formulation reduces uneven edge wear and chipping, improving user experience and extending wheel life.



**WEILER WHEEL**

**INDUSTRY STANDARD**

# SELECTING THE RIGHT ABRASIVE

Weiler's bonded abrasives help Metal Fabrication professionals get the most demanding jobs done right and done fast. Our high-quality line helps you select the best solution for the toughest jobs. Whether you're working in a shipyard, on a pipeline, or in a fab shop, Weiler will get it done for you.



## P MAX PERFORMANCE SUPERIOR LIFE & CUT



CUT RATE: ●●●●●  
LIFE: ●●●●●

### TIGER® CERAMIC

Self-sharpening and cool – grinds at lower temperatures with less friction and less effort, reducing heat discoloration of the work piece.

### GRAIN TYPE

Ceramic alumina

**CONTAMINANT FREE**  
CONTAIN LESS THAN 0.1%  
IRON, SULFUR & CHLORINE

### BEST ON

STEEL / METAL

STAINLESS HARD-TO-GRIND

Hard-to-Grind metals include tool steel, inconel, high nickel alloy, titanium and armored steel

### TIGER® PIPELINE

Designed for bead and angle grinding applications on the pipeline.

### GRAIN TYPE

Zirconia alumina + ceramic alumina infusion

### BEST ON

STEEL / METAL

## P HIGH PERFORMANCE FAST CUT & LONG LIFE



CUT RATE: ●●●●●  
LIFE: ●●●●●

### TIGER ZIRC

Self-sharpening grains retain a high cut rate throughout the life of the wheel for exceptional performance.

### GRAIN TYPE

Cutting/Combo: Zirconia alumina  
Grinding: Zirconia alumina + ceramic alumina infusion

### BEST ON

STEEL / METAL

includes structural steel and cast iron

### TIGER INOX

Tiger INOX wheels deliver a worry-free solution for stainless steel applications.

### GRAIN TYPE

White aluminum oxide

**CONTAMINANT FREE**  
CONTAIN LESS THAN 0.1%  
IRON, SULFUR & CHLORINE

### BEST ON

STAINLESS

and harder grade steel

### TIGER ALUMINUM

Weiler's non-loading formula delivers a fast and consistent cut rate on aluminum and soft alloys.

### GRAIN TYPE

Silicon carbide / aluminum oxide blend

**CONTAMINANT FREE**  
CONTAIN LESS THAN 0.1%  
IRON, SULFUR & CHLORINE

### BEST ON

ALUMINUM

## P PERFORMANCE LONG LIFE



CUT RATE: ●●●●●  
LIFE: ●●●●●

### TIGER AO

Tiger wheels provide an even, sharp, clean cut and a hard bond extends wheel life.

### GRAIN TYPE

Aluminum oxide

### BEST ON

STEEL / METAL

## V VALUE FAST CUT



CUT RATE: ●●●●●  
LIFE: ●●●●●

### WOLVERINE®

Fast cut rate and consistent performance at a good value.

### GRAIN TYPE

Aluminum oxide

### BEST ON

STEEL / METAL

Key:

**P** PERFORMANCE LINE  
Industrial Grade

**V** VALUE LINE  
Professional Grade

Read and Comply with ANSI B7.1



# TYPE

Selecting the best type of abrasive for your application increases effectiveness and user productivity.

## Cutting

### Type 1 (Flat)



### Type 27 (Depressed Center)



## Grinding

### Type 27 (Depressed Center)

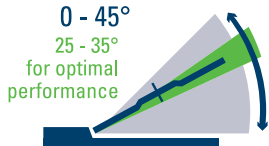

Flat profile with depressed center allows for a wide range of grinding angles (0-45)

### Type 28 (Depressed Center)

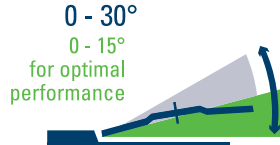

Designed for increased aggression at lower working angles and increased access

### Type 29 (Depressed Center)

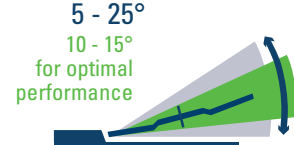

Increases surface contact, deters gouging, and improves operator comfort

### Type 11 Cup



### Type 16 Cone

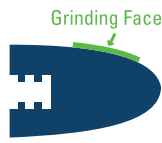

### Type 17 Cone

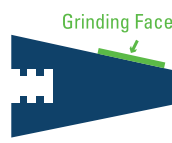

### Type 18 Plug

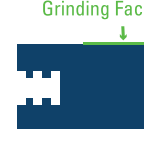

### Type 18R Plug

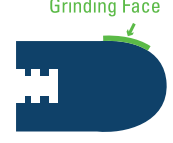

## GRIT / GRAIN / GRADE

Selecting the best grit, grain and grade combination for your application can increase wheel effectiveness and user productivity. Use the charts below to help pick the right wheel for the job.

### Grit

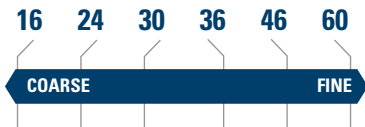

### Grain

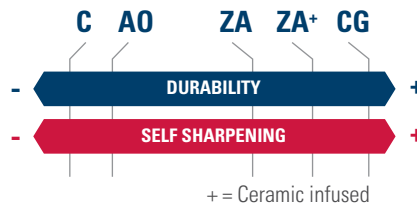

### Grade (Hardness)



## APPLICATION

When selecting a wheel, always choose the thinnest wheel that will perform the cut while maintaining desired product life.

### ULTRA THIN WHEEL 1MM



Sheet metal, tubes, profiles and small cross-section rods

### THIN WHEEL .045"



Tubes, bar stock and large cross-sections

### THIN WHEEL .060"



Angle iron, large cross-sections

### CUTTING WHEEL 3/32"



### PIPELINE NOTCHING WHEEL 1/8"



Notching

### COMBO WHEEL 1/8"



Switching between cutting and grinding

### PIPELINE NOTCHING WHEEL 1/8"



For tough root pass notching & facing applications on the pipeline

### GRINDING WHEEL 1/4"



Heavy stock, scale and weld removal, weld blending, edge beveling and torch-cut softening

### CONES & PLUGS



ID cleaning, hole edge beveling, smoothing weld seams, removing gates & parting lines

### CUP WHEEL



Heavy metal removal, grinding, transitioning, rough beveling & removing crack & flaws

# CUTTING WHEELS

Weiler's diverse line of cutting wheels provides consistent, well-balanced, high quality solutions. From our 1-millimeter cutting wheels that slice through metal to our large diameter wheels for the biggest cuts, professionals get the most demanding jobs done right and done fast.

## FEATURES:

- Additional fiberglass reinforcement provides **added strength** for aggressive cutting
- Smooth outer layer reduces friction for an **effortless cut and less kickback** during operation
- **2.0 Optimum Use Line** helps maximize wheel life, **improving productivity** and sustainability
- **2.0** Longer wheel life **reduces change-overs and delivers more cuts**



UltraCut wheel making precision cuts a steel tube stock.

## TYPE 1 1MM CUTTING WHEELS



58006

58131

## P HIGH PERFORMANCE

### STEEL / METAL TIGER ZIRC ULTRACUT 1MM / Fast Cut & Long Life

Diameter	Thickness	Grade	Max. RPM	Std. Pack	Item #
4-1/2"	1 mm	Z60T	13,300	50	58005
5"	1 mm	Z60T	12,200	50	58006

### STAINLESS TIGER INOX ULTRACUT 1MM / Contaminant-free\*

Diameter	Thickness	Grade	Max. RPM	Std. Pack	Item #
4-1/2"	1 mm	INOX60T	13,300	50	58130
5"	1 mm	INOX60T	12,200	50	58131

\*Contaminant-free (Contains less than 0.1% Fe, S, Cl)

TYPE 1  
7/8" Arbor

CUTS  
**20%**  
FASTER  
than the closest  
competitor

PROPRIETARY  
**SOLID  
CORE  
TECHNOLOGY**

increases wheel density,  
resulting in longer life,  
reduced friction and  
superior stability

A TRUE  
**1MM  
THICKNESS**

delivers precise, consistent  
cuts you can count on

TRUE  
1 MILLIMETER

STANDARD  
.045"



# TYPE 1 & 27 CUTTING WHEELS

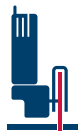

**NEW 2.0** BOLD items only.

## P MAX PERFORMANCE

**STEEL / METAL**  
**STAINLESS**  
**HARD-TO-CUT**

**TIGER CERAMIC**  
Superior Life & Cut  
Contaminant-free\*

Diameter	Thickness	Grade	Max. RPM	TYPE 1 7/8" Arbor		TYPE 27 7/8" Arbor		TYPE 27 5/8"-11 Hub	
				Std. Pack	Item #	Std. Pack	Item #	Std. Pack	Item #
4-1/2"	.045"	CER60S	13,300	25	<b>58300</b>	25	<b>58305</b>	10	<b>58306</b>
5"	.045"	CER60S	12,200	25	<b>58301</b>	25	<b>58307</b>	10	<b>58308</b>
6"	.045"	CER60S	10,200	25	<b>58302</b>	25	<b>58309</b>	10	<b>58310</b>
7"	.060"	CER60S	8,600	25	<b>58303</b>	25	<b>58311</b>	10	<b>58312</b>

**NEW 2.0** BOLD items only.

## P HIGH PERFORMANCE

**STEEL / METAL**

**TIGER ZIRC 2.0** / Fast Cut & Long Life

Diameter	Thickness	Grade	Max. RPM	TYPE 1 7/8" Arbor		TYPE 27 7/8" Arbor		TYPE 27 5/8"-11 Hub	
				Std. Pack	Item #	Std. Pack	Item #	Std. Pack	Item #
4-1/2"	.045"	Z60T	13,300	25	<b>58000</b>	25	<b>58020</b>	10	<b>58030</b>
5"	.045"	Z60T	12,200	25	<b>58001</b>	25	<b>58021</b>	10	<b>58031</b>
6"	.045"	Z60T	10,200	25	<b>58002</b>	25	<b>58022</b>	10	<b>58032</b>
7"	.060"	Z60T	8,600	25	<b>58003</b>	25	<b>58023</b>	10	<b>58033</b>

**STAINLESS**

**TIGER INOX** / Contaminant-free\*

Diameter	Thickness	Grade	Max. RPM	TYPE 1 7/8" Arbor		TYPE 27 7/8" Arbor		TYPE 27 5/8"-11 Hub	
				Std. Pack	Item #	Std. Pack	Item #	Std. Pack	Item #
4-1/2"	.045"	INOX60S	13,300	25	<b>58100</b>	25	<b>58110</b>	10	<b>58109</b>
5"	.045"	INOX60S	12,200	25	<b>58101</b>	25	<b>58111</b>	—	—
6"	.045"	INOX60S	10,200	25	<b>58102</b>	25	<b>58112</b>	10	<b>58113</b>
7"	.060"	INOX60S	8,600	25	<b>58103</b>	25	<b>58107</b>	—	—

**ALUMINUM**

**TIGER ALUMINUM** / Non-loading / Contaminant-free\*

Diameter	Thickness	Grade	Max. RPM	TYPE 1 7/8" Arbor		TYPE 27 7/8" Arbor		TYPE 27 5/8"-11 Hub	
				Std. Pack	Item #	Std. Pack	Item #	Std. Pack	Item #
4-1/2"	.045"	ALU60S	13,300	25	58200	25	58205	10	58206
5"	.045"	ALU60S	12,200	25	58201	—	—	—	—
6"	.045"	ALU60S	10,200	25	58202	25	58209	10	58210
7"	.060"	ALU60S	8,600	25	58203	—	—	—	—

**NEW 2.0** BOLD items only.

## P PERFORMANCE

**STEEL / METAL**

**TIGER AO 2.0** / Long Life

Diameter	Thickness	Grade	Max. RPM	TYPE 1 7/8" Arbor		TYPE 27 7/8" Arbor		TYPE 27 5/8"-11 Hub	
				Std. Pack	Item #	Std. Pack	Item #	Std. Pack	Item #
4-1/2"	.045"	A60T	13,300	25	<b>57020</b>	25	<b>57041</b>	10	<b>57040</b>
	1/16"	A36T		25	<b>57061</b>	—	—	—	—
	3/32"	A36S		—	—	25	<b>57081</b>	10	<b>57080</b>
5"	.045"	A60T	12,200	25	<b>57021</b>	25	<b>57043</b>	10	<b>57042</b>
	3/32"	A36S		—	—	25	<b>57083</b>	10	<b>57082</b>
6"	.045"	A60T	10,200	25	<b>57022</b>	25	<b>57045</b>	10	<b>57044</b>
7"	.060"	A60T	8,600	25	<b>57023</b>	25	<b>57046</b>	10	<b>57048</b>
9"	1/16"	A60T	6,600	—	—	25	<b>57047</b>	10	<b>57049</b>

## V VALUE

**STEEL / METAL**

**WOLVERINE AO** / Fast Cutting

Dia.	Thickness	Grade	Max. RPM	TYPE 1 5/8" Arbor		TYPE 27 5/8" Arbor	
				Pack	Item #	Pack	Item #
4"	.035"	A60T	15,300	25	56271	—	—
4"	3/32"	A24T	15,200	—	—	25	56474
5"	.035"	A60T	12,200	25	56108	—	—

## V VALUE

**STEEL / METAL**

**WOLVERINE AO** / Fast Cutting

Diameter	Thickness	Grade	Max. RPM	TYPE 1 7/8" Arbor		TYPE 27 7/8" Arbor		TYPE 27 5/8"-11 Hub	
				Std. Pack	Item #	Std. Pack	Item #	Std. Pack	Item #
4-1/2"	.045"	A60T	13,300	25	56281	—	—	—	—
	.045"	A60S		—	—	25	56393	—	—
	1/16"	A60T		25	56103	—	—	—	—
	3/32"	A24T		—	—	25	56475	10	56385
5"	.045"	A60S	12,200	—	—	25	56392	—	—
	1/16"	A36T		25	56118	—	—	—	—
	3/32"	A24T		—	—	25	56476	10	56384
6"	.040"	A60T	10,200	25	56282	—	—	—	—
	.045"	A60T		25	56273	—	—	—	—
	.045"	A60S		—	—	25	56283	—	—
	3/32"	A24R		—	—	25	56277	10	56278
7"	.045"	A60T	8,600	25	56275	—	—	—	—
	.060"	A60S		—	—	25	56391	—	—
	3/32"	A24R		—	—	25	56383	10	56477
9"	1/8"	A24T	6,600	—	—	—	—	10	56423

**BLACK BOLD ITEM** numbers indicate Tiger 2.0. \*Contaminant-free (Contains less than 0.1% Fe, S, Cl)





## TYPE 1 SMALL DIAMETER CUTTING WHEELS



58348



58011



57070



56128

### P MAX PERFORMANCE

STEEL / METAL  
STAINLESS  
HARD-TO-CUT

**TIGER® CERAMIC**  
Superior Life & Cut  
Contaminant-free\*

Dia.	Thickness	Grade	Max. RPM	TYPE 1 1/4" Arbor		TYPE 1 3/8" Arbor	
				Std. Pack	Item #	Std. Pack	Item #
3"	1/16"	CER36T	25,000	100	58345	100	58342
4"	1/16"	CER36T	19,000	—	—	25	58348

\*Contaminant-free (Contains less than 0.1% Fe, S, Cl)

### P HIGH PERFORMANCE

STEEL / METAL

**TIGER ZIRC** / Fast Cut & Long Life

Dia.	Thickness	Grade	Max. RPM	TYPE 1 1/4" Arbor		TYPE 1 3/8" Arbor	
				Std. Pack	Item #	Std. Pack	Item #
3"	.035"	Z60T	25,000	100	58012	100	58011
4"	.035"	Z60T	19,000	25	58014	25	58013

### P PERFORMANCE

STEEL / METAL

**TIGER AO** / Long Life

Dia.	Thickness	Grade	Max. RPM	TYPE 1 1/4" Arbor		TYPE 1 3/8" Arbor	
				Std. Pack	Item #	Std. Pack	Item #
2"	.035"	A60T	30,000	100	57014	100	57010
	1/16"	A36T			57015		57011
	1/8"	A36T			57016		57012
3"	.035"	A60T	25,000	100	—	100	57001
	1/16"	A36T			57066		57060
	1/8"	A36T			57068		57063
4"	.035"	A60T	19,000	25	57075	25	57070
	1/16"	A36T			—		57071
	1/8"	A36T			—		57072

### V VALUE

STEEL / METAL

**WOLVERINE® AO** / Fast Cut

Dia.	Thickness	Grade	Max. RPM	TYPE 1 1/4" Arbor		TYPE 1 3/8" Arbor	
				Std. Pack	Item #	Std. Pack	Item #
2"	.035"	A60T	30,000	100	56013	100	56128
	1/16"	A36T		50	56015	50	56129
	1/8"	A36S		50	56022	50	56130
3"	.035"	A60T	25,000	100	56061	100	56062
	1/16"	A36T		100	56065	100	56068
	1/16"	A60T		—	—	100	56070
	1/8"	A36T		—	—	50	56076
	1/8"	A36S		50	56060	—	—
4"	.035"	A60T	19,000	50	56165	50	56080
	1/16"	A36T		50	56166	50	56086
	1/8"	A36T		—	—	50	56099

## TYPE 1 & 27 SMALL DIAMETER SNAGGING WHEELS



57064



56064

### P PERFORMANCE

STEEL / METAL

**TIGER AO** / Long Life

Diameter	Thickness	Grade	Max. RPM	TYPE 1 3/8" Arbor		TYPE 27 3/8" Arbor	
				Std. Pack	Item #	Std. Pack	Item #
3"	1/4"	A24T	25,000	40	57064	—	—
4"	1/4"	A24T	15,300	10	57073	10	57074

### V VALUE

STEEL / METAL

**WOLVERINE® AO** / Fast Cutting

Dia.	Thickness	Grade	Max. RPM	TYPE 1 3/8" Arbor	
				Std. Pack	Item #
2"	1/4"	A60T	30,000	25	56131
3"	1/4"	A24T	25,000	25	56064
4"	1/4"	A36T	15,300	10	56163

• Non-stock product, contact Customer Service for lead times.



## TYPE 1 FOR CHOP SAWS



### P PERFORMANCE

STEEL / METAL **TIGER AO** / Long Life

Diameter	Thickness	Arbor	Grade	Description	Max. RPM	Std. Pack	Item #
12"	3/32"	1"	A36T	Long Life Cutting	5,100	10	57090
14"	3/32"	1"	A36T	Long Life Cutting	4,400	10	57092
14"	3/32"	1"	A36R	Smooth Cutting	4,400	10	57093 ♦
14"	3/32"	1"	EA36T	Fast Cut & Long Life	4,400	10	57086
16"	3/32"	1"	A36P	Long Life Cutting	3,850	10	57087

♦ Softer bond for smoother, faster cutting.

### V VALUE

STEEL / METAL **WOLVERINE AO** / Fast Cutting

Diameter	Thickness	Arbor	Grade	Description	Max. RPM	Std. Pack	Item #
12"	3/32"	1"	A46T	Fast Cutting	5,100	10	56239
14"	3/32"	1"	A46T	Fast Cutting	4,400	10	56240
14"	3/32"	1"	A46T	Single Center Reinforcement For + Speed	4,400	10	56247

## TYPE 1 FOR HIGH SPEED SAWS



### P HIGH PERFORMANCE

STEEL / METAL **TIGER ZIRC** / Fast Cut & Long Life / Rail Cutting

Diameter	Thickness	Arbor	Grade	Description	Max. RPM	Std. Pack	Item #
14"	1/8"	1"	Z24U	Rail Cutting	5,500	10	58028
16"	1/8"	1"	Z24U	Rail Cutting	4,800	10	58029

### P PERFORMANCE

STEEL / METAL **TIGER AO** / Long Life

Diameter	Thickness	Arbor	Grade	Description	Max. RPM	Std. Pack	Item #
12"	1/8"	1"	A30T	Long Life Cutting	6,400	10	57030
14"	1/8"	1"	A30T	Long Life Cutting	5,500	10	57032
14"	1/8"	20 mm	A30T	Long Life Cutting	5,500	10	57094
14"	1/8"	20 mm	A30T	Triple Reinforcement For + Support	5,500	10	57035

## TYPE 1 FOR STATIONARY SAWS



### P PERFORMANCE

STEEL / METAL **TIGER AO** / Long Life

Diameter	Thickness	Arbor	Grade	Description	Max. RPM	Std. Pack	Item #
14"	1/8"	1"	A30R	Long Life Cutting	4,400	10	57091
20"	1/8"	1"	A30S	Long Life Cutting	3,100	10	57097

### V VALUE

STEEL / METAL **WOLVERINE AO** / Fast Cutting

Diameter	Thickness	Arbor	Grade	Description	Max. RPM	Std. Pack	Item #
14"	1/8"	1"	A30R	Fast Cutting	4,400	10	56230

57086

**HIGH**  
PERFORMANCE



56247

**RAIL**  
CUTTING

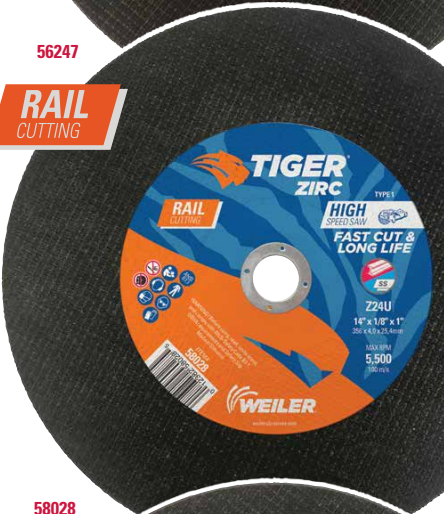

58028

**TRIPLE**  
REINFORCEMENT  
FOR + SUPPORT



# GRINDING WHEELS

0 - 45°

Cut back provides instant aggressive grinding

Whether you're looking for serious stock removal, beveling, grinding, or notching, Weiler's grinding will help get the most demanding jobs done right and done fast.

## FEATURES:

- Fiberglass cut back design provides **aggressive grinding right out of the box** (Tiger 27 grinding wheels only)
- Triple fiberglass reinforcement **increases user safety**
- 2.0 Optimum Use Line** helps maximize wheel life, **improving productivity** and sustainability
- 2.0** Longer wheel life **reduces change-overs and removes more material**
- 2.0** Advanced 2.0 bond formulation **reduces uneven edge wear and chipping**, improving operator experience and extending wheel life



Weld blending on a stainless pressure tank with a Tiger Ceramic grinding wheel.

## TYPE 27 GRINDING WHEELS



**NEW 2.0** BOLD items only.

## P MAX PERFORMANCE

**STEEL / METAL** TIGER CERAMIC /  
**STAINLESS** Superior Life & Cut  
**HARD-TO-GRIND** Contaminant-free\*

Dia.	Thickness	Grade	Max. RPM	TYPE 27 5/8" Arbor		TYPE 27 7/8" Arbor		TYPE 27 5/8"-11 Hub	
				Std. Pack	Item #	Std. Pack	Item #	Std. Pack	Item #
4"	1/4"	CER24R	15,300	10	<b>58335</b>	—	—	—	—
4-1/2"	1/4"	CER24R	13,300	—	—	10	<b>58325</b>	10	<b>58326</b>
5"	1/4"	CER24R	12,200	—	—	10	<b>58327</b>	10	<b>58328</b>
6"	1/4"	CER24R	10,200	—	—	10	<b>58329</b>	10	<b>58330</b>
7"	1/4"	CER24R	8,600	—	—	10	<b>58331</b>	10	<b>58332</b>
9"	1/4"	CER24R	6,600	—	—	10	<b>58333</b>	10	<b>58334</b>

**NEW 2.0** BOLD items only.

## P HIGH PERFORMANCE

**STEEL / METAL** TIGER ZIRC / Ceramic-infused  
Fast Cut & Long Life

Dia.	Thickness	Grade	Max. RPM	TYPE 27 5/8" Arbor		TYPE 27 7/8" Arbor		TYPE 27 5/8"-11 Hub	
				Std. Pack	Item #	Std. Pack	Item #	Std. Pack	Item #
4"	1/4"	Z24T	15,300	10	<b>58069</b>	—	—	—	—
4-1/2"	1/4"	Z24T	13,300	—	—	10	<b>58071</b>	10	<b>58070</b>
5"	1/4"	Z24T	12,200	—	—	10	<b>58073</b>	10	<b>58072</b>
6"	1/4"	Z24T	10,200	—	—	10	<b>58079</b>	10	<b>58078</b>
7"	1/4"	Z24T	8,600	—	—	10	<b>58075</b>	10	<b>58074</b>
9"	1/4"	Z24T	6,650	—	—	10	<b>68384</b>	10	<b>68385</b>

**STAINLESS** TIGER INOX / Contaminant-free\*

4-1/2"	1/4"	INOX24R	13,300	—	—	10	<b>58121</b>	10	<b>58120</b>
5"	1/4"	INOX24R	12,200	—	—	10	<b>58123</b>	10	<b>58122</b>
6"	1/4"	INOX24R	10,200	—	—	10	<b>58129</b>	10	<b>58128</b>
7"	1/4"	INOX24R	8,600	—	—	10	<b>58125</b>	10	<b>58124</b>

**ALUMINUM** TIGER ALUMINUM / Non-loading / Contaminant-free\*

4-1/2"	1/4"	ALU24R	13,300	—	—	10	58225	10	58226
5"	1/4"	ALU24R	12,200	—	—	10	58227	10	58228
6"	1/4"	ALU24R	10,200	—	—	10	58229	10	58230

**BLACK BOLD ITEM** numbers indicate Tiger 2.0. \*Contaminant-free (Contains less than 0.1% Fe, S, Cl)

• Non-stock product, contact Customer Service for lead times.



**NEW 2.0** BOLD items only.

## P PERFORMANCE

STEEL / METAL **TIGER AO** / Long Life

Dia.	Thickness	Grade	Max. RPM	TYPE 27 5/8" Arbor		TYPE 27 7/8" Arbor		TYPE 27 5/8"-11 Hub	
				Std. Pack	Item #	Std. Pack	Item #	Std. Pack	Item #
4-1/2"	1/4"	A24R	13,300	—	—	10	<b>57121</b>	10	<b>57120</b>
5"	1/4"	A24R	12,200	—	—	10	<b>57123</b>	10	<b>57122</b>
6"	1/4"	A24R	10,200	—	—	10	<b>57129</b>	10	<b>57128</b>
7"	1/4"	A24R	8,600	—	—	10	<b>57125</b>	10	<b>57124</b>
9"	1/4"	A24T	6,650	—	—	10	<b>68376</b>	10	<b>68377</b>

BLACK BOLD ITEM numbers indicate Tiger 2.0.



57120



56473

## V VALUE

STEEL / METAL **WOLVERINE AO** / Fast Cutting

Diameter	Thickness	Grade	Max. RPM	TYPE 27 5/8" Arbor		TYPE 27 7/8" Arbor		TYPE 27 5/8"-11 Hub	
				Std. Pack	Item #	Std. Pack	Item #	Std. Pack	Item #
4"	1/4"	A24R	15,200	25	56473	—	—	—	—
4-1/2"	1/4"	A24R	13,300	—	—	25	56464	10	56454
4-1/2"	1/4"	A24N	13,300	—	—	25	56457	10	56455
5"	1/4"	A24R	12,200	—	—	25	56466	10	56449
6"	1/4"	A24R	10,200	—	—	25	56280	10	56279
7"	1/4"	A24R	8,600	—	—	25	56467	10	56468
9"	1/4"	A24R	6,600	—	—	25	56469	10	56470

## TYPE 28 GRINDING WHEELS



**NEW 2.0** BOLD items only.

## P HIGH PERFORMANCE

STEEL / METAL **TIGER ZIRC** / Ceramic-infused  
Fast Cut & Long Life

Diameter	Thickness	Grade	Max. RPM	TYPE 28 7/8" Arbor		TYPE 28 5/8"-11 Hub	
				Std. Pack	Item #	Std. Pack	Item #
7"	1/4"	Z24T	8,600	10	<b>58081</b>	10	<b>58080</b>
9"	1/4"	Z24T	6,600	10	<b>58083</b>	10	<b>58082</b>



58081



57134

**NEW 2.0** BOLD items only.

## P PERFORMANCE

STEEL / METAL **TIGER AO** / Long Life

Diameter	Thickness	Grade	Max. RPM	TYPE 28 7/8" Arbor		TYPE 28 5/8"-11 Hub	
				Std. Pack	Item #	Std. Pack	Item #
7"	1/4"	A24R	8,600	10	<b>57135</b>	10	<b>57134</b>
9"	1/4"	A24R	6,600	10	<b>57137</b>	10	<b>57136</b>

BLACK BOLD ITEM numbers indicate Tiger 2.0.

## TYPE 29 MILL SCALE GRINDING WHEELS



Weiler Tiger mill scale wheels offer a high-performance solution for removing tough mill scale from hot-rolled carbon steel. They will maximize removal rates, increase productivity and operator comfort, deter gouging, ensure proper coating adhesion, and safeguard the quality of critical welds.

**NEW**

## P HIGH PERFORMANCE GRINDING

STEEL / METAL **TIGER ZIRC** / Fast Cut & Long Life

Dia.	Thickness	Grade	Max. RPM	TYPE 29 5/8"-11 Hub	
				Std. Pack	Item #
4-1/2"	1/8"	MILL30T	13,300	10	<b>58086</b>
5"	1/8"	MILL30T	12,200	10	<b>58087</b>
6"	1/8"	MILL30T	10,200	10	<b>58088</b>



58086

# COMBO WHEELS



Weiler's combination wheels offer flexibility and efficiency when switching between cutting and grinding applications.

## FEATURES:

- **2.0 Optimum Use Line** helps maximize wheel life, **improving productivity** and sustainability
- **2.0** Longer wheel life **reduces change-overs and removes more material**



Back gouging a steel plate with a Tiger combo wheel.

## TYPE 27

## CUT & GRIND COMBO WHEELS



**NEW 2.0** BOLD items only.

## P MAX PERFORMANCE

**STEEL / METAL** **TIGER CERAMIC**  
**STAINLESS** Superior Life & Cut  
**HARD-TO-GRIND** Contaminant-free\*

Diameter	Thickness	Grade	Max. RPM	Std. Pack	Item #	Std. Pack	Item #
4-1/2"	1/8"	CER30T	13,300	25	<b>58315</b>	10	<b>58316</b>
5"	1/8"	CER30T	12,200	25	<b>58317</b>	10	<b>58318</b>
6"	1/8"	CER30T	10,200	25	<b>58319</b>	10	<b>58320</b>
7"	1/8"	CER30T	8,600	25	<b>58321</b>	10	<b>58322</b>
9"	1/8"	CER30T	6,600	25	<b>58323</b>	10	<b>58324</b>

TYPE 27  
7/8" Arbor

TYPE 27  
5/8"-11 Hub

**NEW 2.0** BOLD items only.

## P HIGH PERFORMANCE

**STEEL / METAL** **TIGER ZIRC** / Fast Cut & Long Life

Diameter	Thickness	Grade	Max. RPM	Std. Pack	Item #	Std. Pack	Item #
4-1/2"	1/8"	Z30T	13,300	25	<b>58051</b>	10	<b>58050</b>
5"	1/8"	Z30T	12,200	25	<b>58053</b>	10	<b>58052</b>
6"	1/8"	Z30T	10,200	25	<b>58064</b>	10	<b>58054</b>
7"	1/8"	Z30T	8,600	25	<b>58056</b>	10	<b>58055</b>
9"	1/8"	Z30T	6,650	25	<b>68382</b>	10	<b>68383</b>

TYPE 27  
7/8" Arbor

TYPE 27  
5/8"-11 Hub

**STAINLESS** **TIGER INOX** / Contaminant-free\*

4-1/2"	1/8"	INOX30T	13,300	25	<b>58115</b>	10	<b>58114</b>
--------	------	---------	--------	----	--------------	----	--------------

**ALUMINUM** **TIGER ALUMINUM** / Non-loading / Contaminant-free\*

4-1/2"	1/8"	ALU30T	13,300	25	<b>58215</b>	10	<b>58216</b>
--------	------	--------	--------	----	--------------	----	--------------

**NEW 2.0** BOLD items only.

## P PERFORMANCE

**STEEL / METAL** **TIGER AO** / Long Life

Diameter	Thickness	Grade	Max. RPM	Std. Pack	Item #	Std. Pack	Item #
4-1/2"	1/8"	A30S	13,300	25	<b>57101</b>	10	<b>57100</b>
5"	1/8"	A30S	12,200	25	<b>57103</b>	10	<b>57102</b>
6"	1/8"	A30S	10,200	25	<b>57109</b>	10	<b>57108</b>
7"	1/8"	A30S	8,600	25	<b>57105</b>	10	<b>57104</b>
9"	1/8"	A30T	6,650	25	<b>68374</b>	10	<b>68375</b>

TYPE 27  
7/8" Arbor

TYPE 27  
5/8"-11 Hub

## V

## VALUE

**STEEL / METAL** **WOLVERINE AO** / Fast Cutting

Diameter	Thickness	Grade	Max. RPM	Std. Pack	Item #	Std. Pack	Item #
4-1/2"	1/8"	A24T	13,300	25	56430	10	56429
5"	1/8"	A24T	12,200	25	56428	10	56427
7"	1/8"	A24T	8,600	25	56426	10	56425

TYPE 27  
7/8" Arbor

TYPE 27  
5/8"-11 Hub



# PIPELINE WHEELS

## TYPE 27 FOR PIPELINE



Weiler's Pipeline Grinding Wheels are designed specifically for pipeline applications. Whether grinding a bead, facing the land, prepping transitions, or fabricating in the yard, this wheel is ready to work out of the box, delivering consistent, aggressive grinding throughout the life of the wheel, eliminating the need to chip it.

### FEATURES:

- **Do Not Chip** – Operators will no longer feel the need to chip the wheel to get it to bite.
- **Reduced Chatter** – A unique bond formulation delivers reduced vibration for the entire life of the wheel for a better grinding experience.
- **Superior Life & Cut** – A blend of zirconia alumina and ceramic grains bite into the bead and dig out the wagon tracks fast while the strong bond delivers long wheel life.



### One Wheel for



GRINDING NOTCHING

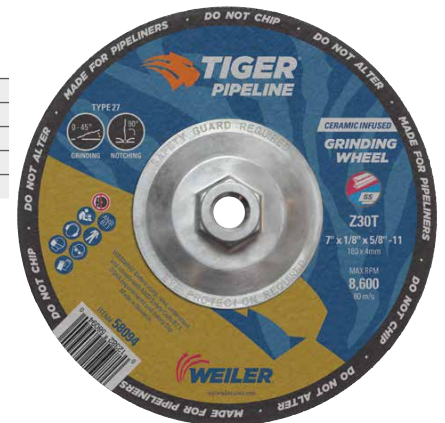

58094



NOTCHING



58066



56495



56489



04455

## P HIGH PERFORMANCE PIPELINE GRINDING WHEELS

STEEL / METAL TIGER ZIRC / Ceramic-infused / Fast Grinding & Long Life on Pipe

Diameter	Thickness	Grade	Max. RPM	Std. Pack	Item #
4-1/2"	1/8"	Z30T	13,300	10	58090
6"	1/8"	Z30T	10,200	10	58092
7"	1/8"	Z30T	8,600	10	58094
9"	1/8"	Z30T	6,600	10	58095

TYPE 27  
5/8"-11 Nut

## TYPE 27 FOR MECHANIZED PIPE WELDING



Weiler's Tiger Mech Wheels are designed for notching applications on mechanical pipe welds. These high-performance wheels are thinner than standard pipe notching wheels, allowing the operator to grind the bead without widening or scarring the bevel.

### FEATURES:

- **Designed to Fit** – Tiger Mech reaches the bead without widening the bevel.
- **Optimized Performance** – Designed specifically to grind starts and stops on J and K bevels.
- **Superior Life & Cut** – A blend of Zirconia Alumina and Ceramic grains bite into the bead fast while the strong bond delivers long wheel life.

## P HIGH PERFORMANCE MECH NOTCHING WHEELS

STEEL / METAL TIGER ZIRC / Ceramic-infused / Notching Mechanized Pipe Welds

Diameter	Thickness	Grade	Max. RPM	Std. Pack	Item #
4-1/2"	3/32"+	Z30T	13,300	10	58066
7"	3/32"+	Z30T	8,600	10	58068

TYPE 27  
5/8"-11 Nut

+ Specific size for mechanized pipe welds

## ACCESSORIES

### ADAPTING NUTS & SPANNER WRENCH For 4" - 6" Angle Grinders.

Description	Adapts To	Min. Wheel Thickness	Standard Pack	Item Number
Adapting Nuts	5/8" to 3/8"-24	.045"	1	56484
Adapting Nuts	7/8" to 5/8"-11	.045"	1	56494
Spanner Wrench	—	—	1	56495

### MOUNTING MANDRELS 1/4" Stem. For Type 1 Wheels Only.

Arbor Size	Wheel Thickness	Standard Pack	Item Number
1/4"	1/8" to 1/4"	10	56489
3/8"	1/8" to 1/4"	10	56490
1/4", 3/8" *	1/8" to 1/4"	10	56491*

\*Combination pack

### ADAPTER for mounting Large Cutting Wheels onto a 20mm arbor.

For Arbor Hole Size	Adapted Arbor Hole Size	Standard Pack	Item Number
1"	20mm	10	04455

# FLARING CUP WHEELS, CONES & PLUGS



Tiger cups, cones, and plugs provide high performance grinding solutions for the toughest materials and the most challenging applications.



Type 11 cup aggressively removing metal.

## FEATURES:

- Precision balanced to ensure smooth, **vibration free operation and reduced operator fatigue**
- Anchored hexagon nut locks the abrasive in place to **increase safety** and prevent product breakage
- Zinc plated nut prevents oxidation, eliminates contamination, and allows for easy mounting
- Open face design on cones and plugs provides an **aggressive cut-rate right out of the box**

## TYPE 11 CUPS FOR GRINDERS



## APPLICATIONS:

Heavy metal removal, grinding, transitioning, rough beveling and removing cracks/flaws

## RIM (W) WIDTH OPTIONS

<b>1-1/2" RIM</b>	Large grinding zone to minimize grind time
<b>1" RIM</b>	Medium grinding zone for maximum material removal in targeted areas
<b>3/4" RIM</b>	Ideal for targeted material removal in small, hard-to-access areas

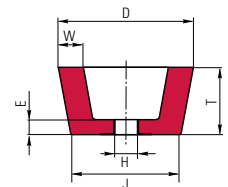

68352



68356



73054



## HIGH PERFORMANCE

### STEEL / METAL TIGER ZIRC CUP WHEELS / Fast Cut & Long Life

Diameter (D / J)	Thickness (T)	Arbor (H)	Rim (W)	Back (E)	Grade	Max. RPM	Std. Pack	Item #
4" / 3"	2"	5/8"-11	3/4"	3/4"	ZA16Q	9,070	5	68352
5" / 3-3/4"	2"	5/8"-11	1"	3/4"	ZA16Q	7,260	5	68355
6" / 4-3/4"	2"	5/8"-11	1"	3/4"	ZA16Q	6,000	5	68358
6" / 4-3/4"	2"	5/8"-11	1-1/2"	3/4"	ZAC16Q	6,000	5	68361+
6" / 4-3/4"	2"	5/8"-11	1-1/2"	3/4"	ZA16R	6,000	5	68362
6" / 4-3/4"	2"	5/8"-11	1-1/2"	3/4"	ZA16Q	6,000	5	68364

+ Includes silicon carbide for burnt-in sand and hard-to-grind metals.



## PERFORMANCE

### STEEL / METAL TIGER AO CUP WHEELS / Long Life

Diameter (D / J)	Thickness (T)	Arbor (H)	Rim (W)	Back (E)	Grade	Max. RPM	Std. Pack	Item #
4" / 3"	2"	5/8"-11	3/4"	3/4"	A16Q	9,070	5	68350 •
5" / 3-3/4"	2"	5/8"-11	1"	3/4"	A16Q	7,260	5	68353
6" / 4-3/4"	2"	5/8"-11	1"	3/4"	A16Q	6,000	5	68356
6" / 4-3/4"	2"	5/8"-11	1-1/2"	3/4"*	A16Q	6,000	5	68359

\*Reinforced metal back

## CUP WHEEL MOUNTING FLANGE - Fits over 5/8"-11 spindles

Diameter	Thickness	Std. Pack	Item #
2"	1/4"	1	73054 •

• Non-stock product, contact Customer Service for lead times.



## CONES AND PLUGS

# FOR STRAIGHT & DIE GRINDERS



## APPLICATIONS:

ID cleaning, hole edge beveling,  
smoothing weld seams, removing  
parting lines and cleaning castings  
in hard-to-reach places

### P TYPE 16 CONES

#### HIGH PERFORMANCE **STEEL / METAL** TIGER ZIRC TYPE 16 CONES / Fast Cut & Long Life

Diameter (D)	Thickness (T)	Arbor (Thread)	Grade	Max. RPM	Std. Pack	Item #
1"	3"	3/8"-24 Nut	ZA20S	36,290	12	68301
1-1/2"	2-1/2"	5/8"-11 Nut	ZA20S	24,190	12	68304
1-1/2"	2"	3/8"-24 Nut	ZA20S	24,190	12	68306
1-1/2"	3"	5/8"-11 Nut	ZA20S	24,190	12	68308
2"	3"	5/8"-11 Nut	ZA20S	18,145	12	68311
2-3/4"	3-1/2"	5/8"-11 Nut	ZA20S	13,195	12	68313

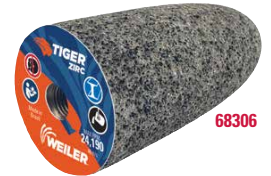
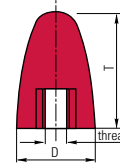

#### PERFORMANCE **STEEL / METAL** TIGER AO / Long Life

Diameter (D)	Thickness (T)	Arbor (Thread)	Grade	Max. RPM	Std. Pack	Item #
1-1/2"	2-1/2"	5/8"-11 Nut	A24R	24,190	12	68303
1-1/2"	3"	3/8"-24 Nut	A24R	24,190	12	68305
1-1/2"	3"	5/8"-11 Nut	A24R	24,190	12	68307
2"	3"	3/8"-24 Nut	A24R	18,145	12	68309
2"	3"	5/8"-11 Nut	A24R	18,145	12	68310
2-3/4"	3"	5/8"-11 Nut	A24R	13,195	12	68312
3"	3"	5/8"-11 Nut	A24R	12,100	12	68314

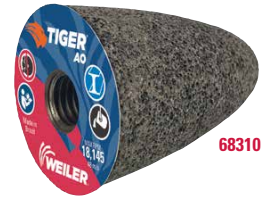

### P TYPE 17 CONES

#### HIGH PERFORMANCE **STEEL / METAL** TIGER ZIRC TYPE 17 CONES / Fast Cut & Long Life

Diameter (D)	Thickness (T)	Arbor (Thread)	Grade	Max. RPM	Std. Pack	Item #
2"	3"	5/8"-11 Nut	ZA20S	18,145	12	68365

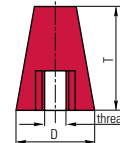

#### PERFORMANCE **STEEL / METAL** TIGER AO / Long Life

Diameter (D)	Thickness (T)	Arbor (Thread)	Grade	Max. RPM	Std. Pack	Item #
1-3/4"	3"	5/8"-11 Nut	A24R	20,740	12	68316
2"	3"	5/8"-11 Nut	A24R	18,145	12	68317

### P TYPE 18 PLUGS

#### HIGH PERFORMANCE **STEEL / METAL** TIGER ZIRC TYPE 18 PLUGS / Fast Cut & Long Life

Diameter (D)	Thickness (T)	Arbor (Thread)	Grade	Max. RPM	Std. Pack	Item #
1-1/2"	2-1/2"	5/8"-11 Nut	ZA20S	24,190	12	68320
1-1/2"	3"	5/8"-11 Nut	ZA20S	24,190	12	68322
2"	3"	5/8"-11 Nut	ZA20S	18,145	12	68324

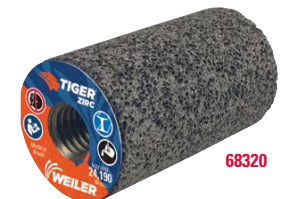
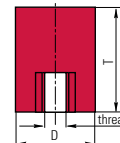

#### PERFORMANCE **STEEL / METAL** TIGER AO / Long Life

Diameter (D)	Thickness (T)	Arbor (Thread)	Grade	Max. RPM	Std. Pack	Item #
1-1/2"	2-1/2"	3/8"-24 Nut	A24R	24,190	12	68318
1-1/2"	2-1/2"	5/8"-11 Nut	A24R	24,190	12	68319
1-1/2"	3"	5/8"-11 Nut	A24R	24,190	12	68321
2"	3"	5/8"-11 Nut	A24R	18,145	12	68323

### P TYPE 18R PLUGS

#### HIGH PERFORMANCE **STEEL / METAL** TIGER ZIRC TYPE 18R PLUGS / Fast Cut & Long Life

Diameter (D)	Thickness (T)	Arbor (Thread)	Grade	Max. RPM	Std. Pack	Item #
1-1/2"	3"	3/8"-24 Nut	ZA20S	24,190	12	68326
1-1/2"	3"	5/8"-11 Nut	ZA20S	24,190	12	68328
2"	3"	5/8"-11 Nut	ZA20S	18,145	12	68330

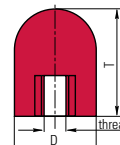

#### PERFORMANCE **STEEL / METAL** TIGER AO / Long Life

Diameter (D)	Thickness (T)	Arbor (Thread)	Grade	Max. RPM	Std. Pack	Item #
1-1/2"	3"	5/8"-11 Nut	A24R	24,190	12	68327
2"	3"	5/8"-11 Nut	A24R	18,145	12	68329
3"	3"	5/8"-11 Nut	A24R	12,100	12	68331



For the full offering of Weiler products, please refer to our Full Line Catalog or visit our website. To discuss specific requirements with a product specialist, call 800.835.9999.

## WEILER ABRASIVES GROUP

**Weiler Global HQ**  
**One Weiler Drive**  
**Cresco, PA 18326 USA**

Weiler de México  
Querétaro, México

Weiler do Brasil  
São Paulo, Brazil

Weiler EMEA HQ  
Maribor, Slovenia

Zreče, Slovenia

Loče, Slovenia

Oplotnica, Slovenia

Bindlach, Germany

