

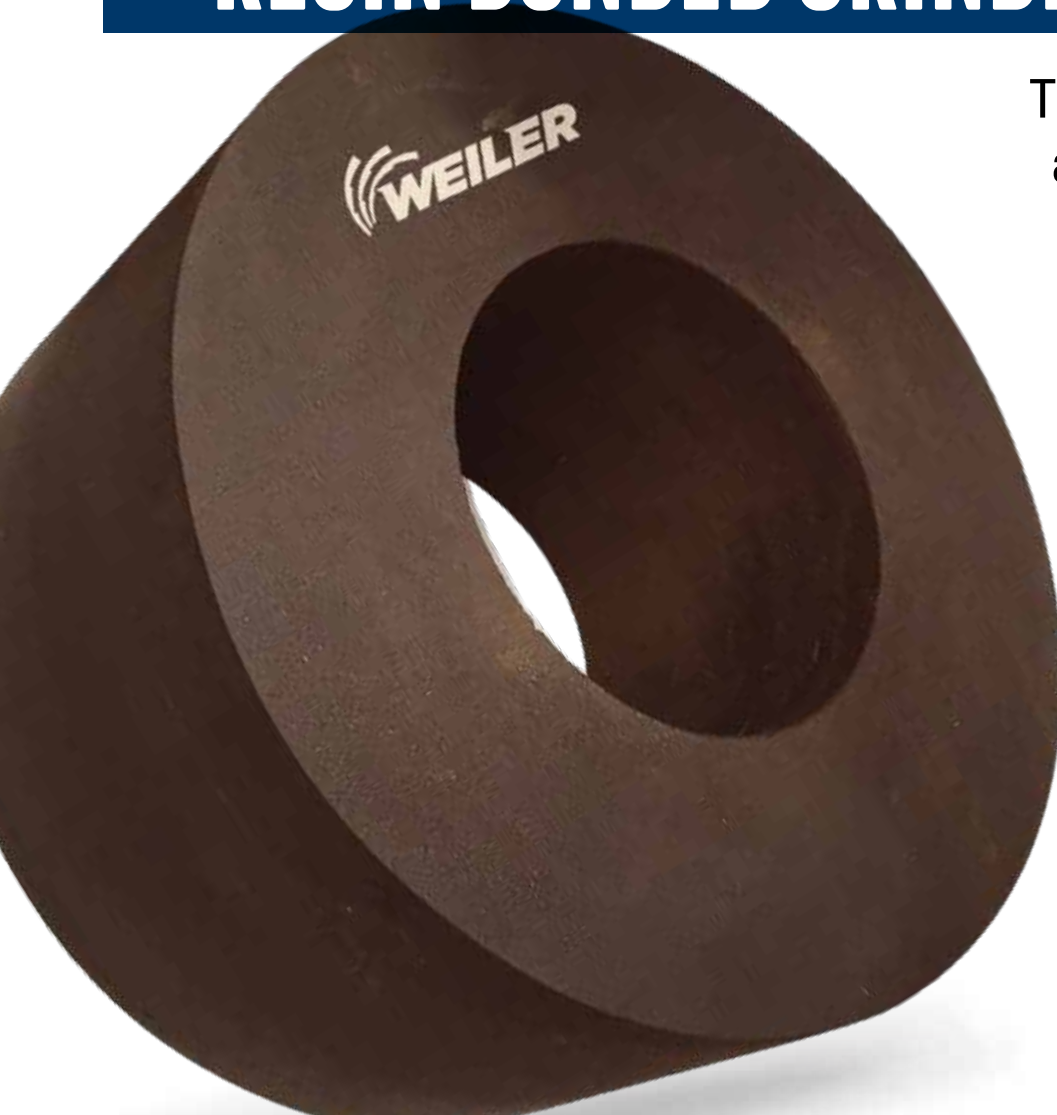

CENTERLESS-CR

RESIN BONDED GRINDING WHEELS



These grinding wheels are used for the mass production roughing and finishing of cylindrical shape workpieces.

**Grinding wheels
in resin bond for
through-feed
centerless.**

RESIN BONDED GRINDING WHEELS

CENTERLESS-CR

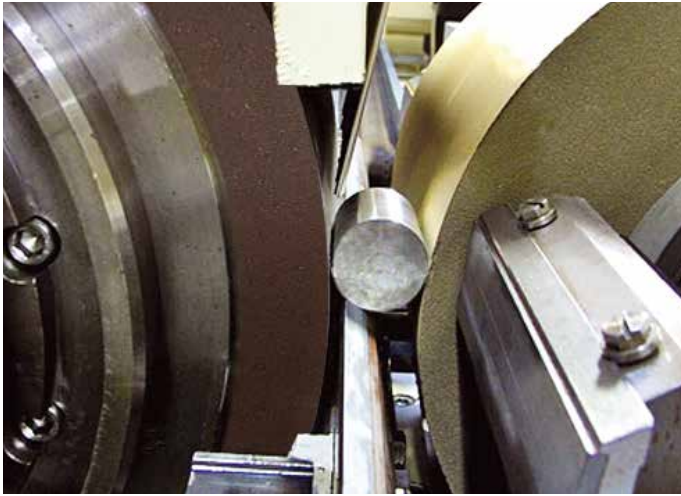

Features:

- faster material removal
- good surface quality after fine grinding
- achieving high-accuracy roundness and cylindricity of the workpiece and good dimension accuracy
- good profile holding capability and long lifetime of the wheel
- grinding application from rough, medium to fine grinding.

1

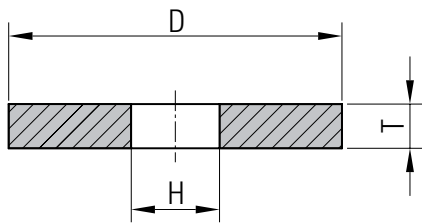

7

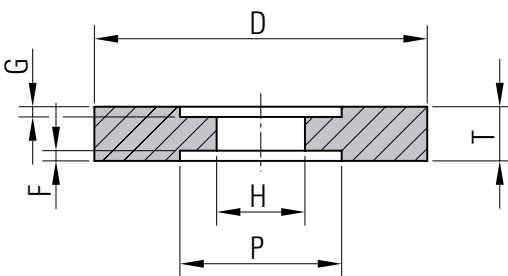

Shape	Dimensions (D x T x H) mm
1	400 x 200 x 203,2
7	500 x 250 x 254-355 x 25/25
1	600 x 250 x 355
1RS	610 x 508 x 304,8

Material	Specification	Surface finish (Ra)
Stainless Steel	SC 46/2 L7 BX23	0,8
Carbon Steel	S57 C70-90/2 J9BX23	0,3 - 0,4

